

FORD AX4N (4F50N)

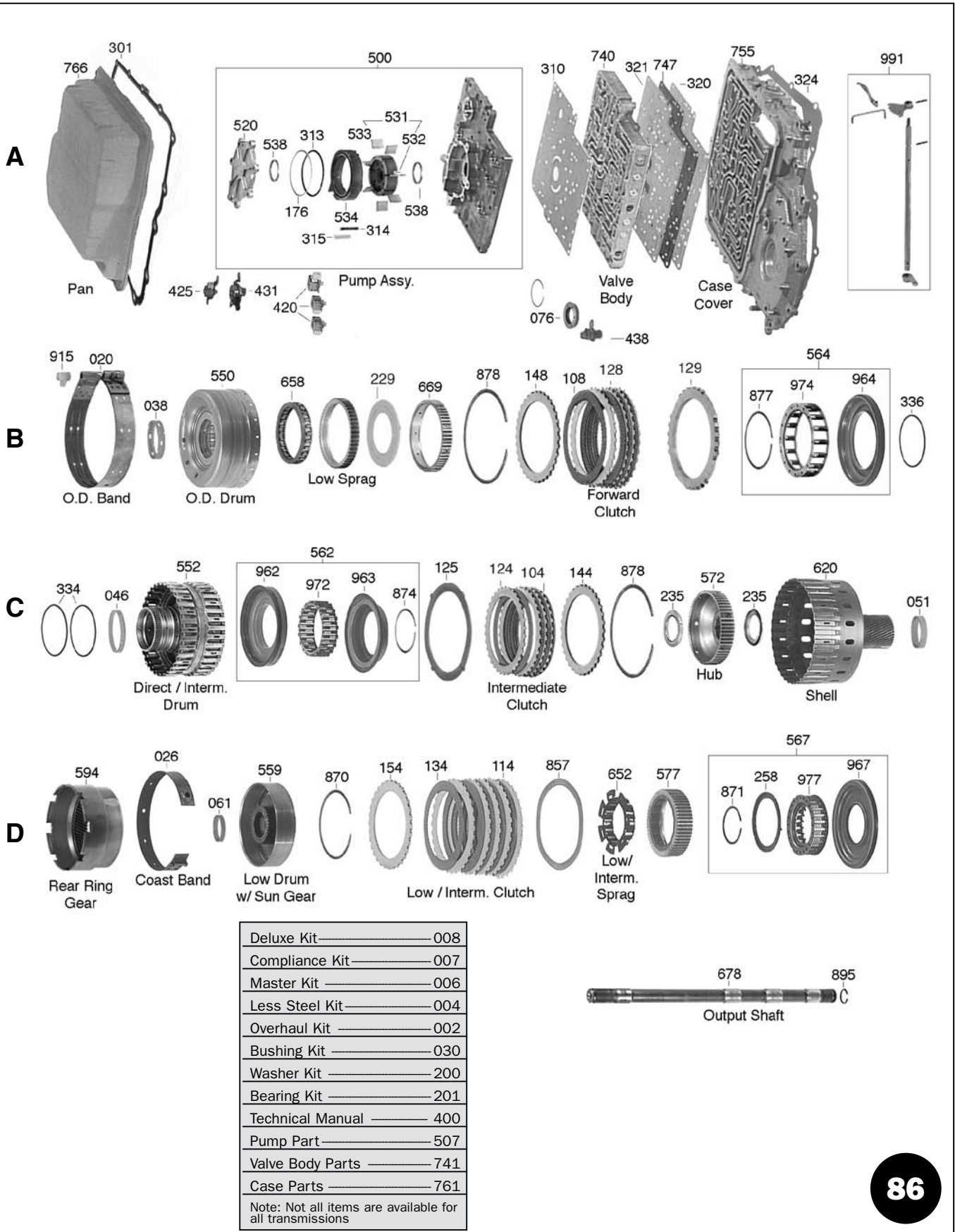

FORD AX4N (4F50N)

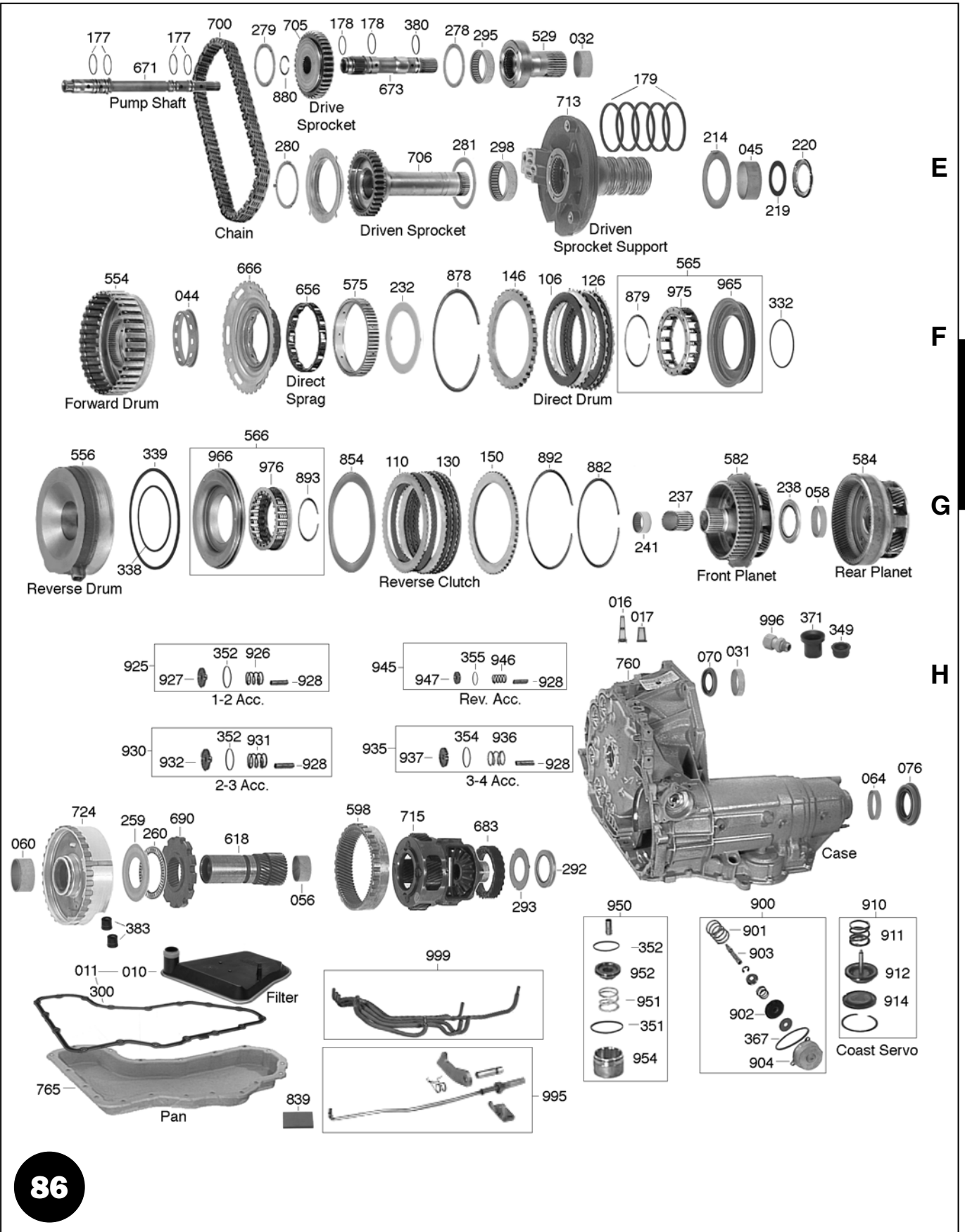

FORD AX4N (4F50N)



86010E
(Orange Seal)



86010H
(Green Seal)

AX4N	
Taurus	95-Up
Lincoln	95-Up
Windstar	01-Up

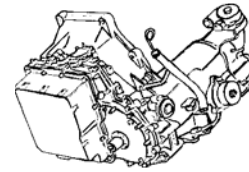
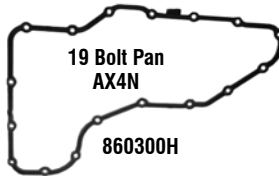

Front Wheel Drive

ILL.	DESCRIPTION	QTY.	YEAR	PART NO.	REFERENCE NO.
DELUXE KITS (SUPER KITS) (1)					
008D	AX4N w/ 86010E Filter (w/ Bonded Pistons)	1	95-99	86008HPW	N/A
008D	AX4N w/ 86010H Filter (w/ Bonded Pistons)	1	95-99	86008HAPW	N/A
008D	AX4N, 4F50N (w/ Bonded Pistons)	1	00-03	86008HBPW	N/A
008D	AX4N, 4F50N (w/ Bonded Pistons)	1	04-Up	86008HCPW	N/A
COMPLIANCE KITS (CALIFORNIA KITS) (1)					
007D	AX4N w/ 86010E Filter (w/ Bonded Pistons)	1	95-99	86007HPW	CK6700F-R
007D	AX4N w/ 86010H Filter (w/ Bonded Pistons)	1	95-99	86007HAPW	N/A
007D	AX4N, 4F50N (w/ Bonded Pistons)	1	00-03	86007HBPW	N/A
007D	AX4N, 4F50N (w/ Bonded Pistons)	1	04-Up	86007HCPW	N/A
MASTER OVERHAUL KITS (WITH STEELS) (1)					
006D	AX4N (w/ Bonded Pistons)	1	95-99	86006HPW	K6700F
006D	AX4N, 4F50N (w/ Bonded Pistons)	1	00-03	86006HBPW	K6700K
006D	AX4N, 4F50N (w/ Bonded Pistons)	1	04-Up	86006HCPW	K6700N
LESS STEEL KITS (1)					
004D	AX4N (w/ Bonded Pistons)	1	95-99	86004HPW	K6700F-LS
004D	AX4N, 4F50N (w/ Bonded Pistons)	1	00-03	86004HBPW	K6700K-LS
004D	AX4N, 4F50N (w/ Bonded Pistons)	1	04-Up	86004HCPW	K6700N-LS
OVERHAUL KITS (W/ RINGS & SEALS) (1)					
002D	AX4N (w/ Bonded Pistons)	1	95-99	86002HPW	K67900M
002D	AX4N (w/o Bonded Pistons)	1	95-99	86002HW	K67900F
002D	AX4N, 4F50N (w/ Bonded Pistons)	1	00-03	86002HBPW	N/A
002D	AX4N, 4F50N (w/o Bonded Pistons)	1	00-03	86002HBW	K67900K
002D	AX4N, 4F50N (w/o Bonded Pistons)	1	04-Up	86002HCW	K67900N
GASKET & SEAL KITS (W/O RINGS & SEALS) (1)					
000D	AX4N	1	95-99	86000HW	K67900F-1
FILTER KITS (1)					
011H	Filter Kit w/ .490" Orange Lip Seal	1	95-Up	86011HW	FK67800F
011H	Filter Kit w/ .420" Green Lip Seal	1	95-Up	86011HAW	FK67800G
<p>(1) - "W" suffix kits incl. Bonded pan gasket. To order Kits with Fiber pan gaskets, change the "W" to an "F".</p> <p>None of these Kits come w/ Pump or Valve Body Bonded Plate Gaskets</p>					
FILTERS					
010H	Filter w/ .490" Orange Lip Seal	1	95-Up	86010E	67800C
010H	Filter w/ .420" Green Lip Seal	1	95-Up	86010H	67800D
016H	Screen, By-Pass Solenoid	1	95-Up	86016	67712
016H	Screen, Valve Body (Square)	1	95-Up	86016A	67712C

FORD AX4N (4F50N)

ILL.	DESCRIPTION	QTY.	YEAR	PART NO.	REFERENCE NO.
BANDS					
Prefix Key: B = Borg Warner, A = OEM (Exc. BW), N = All Other New, R = Relined					
020B	Overdrive	1	95-Up	86020	67520
026D	Coast (1" Wide)	1	95-Up	86026H	67525
915	Plug, Overdrive Band Anchor	1	95-Up	86915	67611
BUSHINGS					
030D	Bushing Kit	1	95-Up	86030H	K67901C
031H	Converter Hub	1	95-Up	86031	67001
032E	Converter Reactor	1-2	95-Up	64047	51008
038B	Overdrive Drum (w/ 6 Slots)	1	95-Up	86038	67013
044F	Inner Sprag Race (1/2" Wide)	1	95-Up	86044	67011
044F	Inner Sprag Race (5/8" Wide)	1	95-Up	86044A	67011A
045E	Driven Sprocket Support	1	95-Up	86045	67009
046C	Direct/Intermediate Clutch Drum	1	95-Up	86046	67008
051C	Sun Shell (1.613"OD)	1	95-Up	86051A	67004A
051C	Sun Shell (Replaces Bearing # 86241)	1	95-Up	86051B	67004X
053	Bearing, In Front Planet	1	95-Up	86241	67003B
053	Replaces Bearing In Front Planet (After Market)	1	95-Up	86053B	67003X
053	Bushing & Sleeve Kit (86053B & 86053S)	1	95-Up	86053BK	N/A
053	Sleeve, Aluminum Lube Sleeve (Between Front Planet & 4th Clutch Hub)	1	95-Up	86053S	67910
056H	Final Drive Sun Gear	1	95-Up	86056	67007
058G	Rear Planet	1	95-Up	86058	67014
060H	Differential Support (Wide)	1	95-Up	86060H	67006B
061D	Rear Drum w/ Sun Gear (1.974"OD)	1	95-96	86061	67005
064H	Rear Case, Final Drive Output Support	1	95-Up	86064	67012
209	Replaces Pump Needle Bearing	1	95-Up	86209B	N/A
209	Bearing, Pump Shaft (1.002"OD)	1	96-99	86209C	67922A
209	Bearing, Pump Shaft (1.065"OD)	1	00-Up	86209H	67922B
METAL CLAD SEALS					
070H	Front	1	95-Up	86070	67200
074	Main Control Shaft	1	95-Up	86074	67202
076A	Axle (Both)	2	95-Up	86076	67201
076A	Axle, Differential (Both)	2	95-Up	86076A	67201B
079	Pump Drive	1	95-Up	86079	67203
FRICION PLATES					
104C	Intermediate	5	95-Up	86106	67404
104C	Intermediate (Hi Energy) (use w/ Kolene Steels)	5	95-Up	86106H	67404H
104C	Intermediate (Hi Energy) (use w/ Non Kolene Steels) 2nd Design	5	95-Up	86106A	67404J
106F	Direct	4-5	95-Up	86106	67404
106F	Direct (Hi Energy) (use w/ Kolene Steels)	4-5	95-Up	86106H	67404H
106F	Direct (Hi Energy) 2nd Design (use w/ Non Kolene Steels) 2nd Design	4-5	95-Up	86106A	67404J
108B	Forward	4	95-Up	86108A	67304A
110G	Reverse	4-5	95-Up	86110	67504
114D	Low/ Intermediate	5	95-Up	86114H	67604
STEEL PLATES					
124C	Intermediate (.070")	5	95-Up	86126	67405
124C	Intermediate (.070") (Kolene)	5	95-Up	86126B	67405K
124C	Intermediate (.095")	4-5	95-Up	86126C	67305A
124C	Intermediate (.095") (Kolene)	4-5	95-Up	86126H	67305AK
125C	Steel Cushion, Intermediate	1	95-Up	86129HA	67715C
126F	Direct (.070")	5	95-Up	86126	67405
126F	Direct (.070") (Kolene)	5	95-Up	86126B	67405K

AX4N

FORD AX4N (4F50N)

ILL.	DESCRIPTION	QTY.	YEAR	PART NO.	REFERENCE NO.
STEEL PLATES (Cont.)					
126F	Direct (.095")	4-5	95-Up	86126C	67305A
126F	Direct (.095") (Kolene)	4-5	95-Up	86126H	67305AK
128B	Forward	4	95-Up	86126E	67405A
128B	Forward (Kolene)	4	95-Up	86126EK	67405AK
129	Steel Cushion, Forward	1	95-Up	86129H	67715E
130G	Reverse (.059")	4	98-Up	86130H	67505A
130G	Reverse (.068")	4	95-Up	86130	67505
134D	Low/ Intermediate	5	95-Up	86134H	67605
854G	Cushion Spring, Reverse	1	95-Up	86854	67715
857D	Cushion Spring, Low/ Intermediate	1	95-Up	86857H	67715H
139	Steel Module	1	95-Up	86139H	N/A
PRESSURE PLATES					
Prefix Key: D = OEM, A = Aftermarket New, R = Remanufactured					
146F	Direct (.130")	1	95-Up	86146H	67714H
146F	Direct (.156")	1	95-Up	86146	67714A
148B	Forward (.170")	1	95-Up	86148HA	67714G
148B	Forward (.278")	1	95-Up	86148HC	67714E
150G	Reverse	1	95-Up	86150	67714
154D	Low & Intermediate (.196")	1	95-Up	86154H	67714K
154D	Low & Intermediate (.330")	1	95-Up	86154HA	67714L
VALVE BODY RECALIBRATION KITS					
165D	Shift Kit®, AX4N/ 4F50N (Transgo®)	1	95-Up	T86165H	K67908N
165D	Sure Cure Kit (req T-96201-TL, T-96201-TL2, T-96201-TL3, T-96201-BST) (Sonmax)	1	95-Up	S86174H	67S04
SEALING RINGS					
175D	Ring Kit (Metal)	1	95-Up	86175	K67903
175D	Ring Kit (Teflon)	1	95-Up	86175T	K67903T
176A	Pump Slide 3.079"OD (Metal)	1	95-Up	86176	67302
177E	Pump Shaft (Front) .693"OD (Teflon)	2	95-Up	86177AT	67306
177E	Pump Shaft (Rear) .833"OD (Teflon)	2	95-Up	86177BT	67309
179E	Forward & Direct 2.466"OD (Metal)	5	95-Up	86179	67301
179E	Forward & Direct 2.466"OD (Teflon)	5	95-Up	86179T	67301T
THRUST WASHERS					
200D	Washer Kit	1	95-Up	86200A	K67907A
214E	Driven Sprocket Support to Overdrive Drum .088"	1	95-Up	86214	67409
214E	Driven Sprocket Support to Overdrive Drum .098"	1	95-Up	86214A	67409A
214E	Driven Sprocket Support to Overdrive Drum .107"	1	95-Up	86214B	67409B
214E	Driven Sprocket Support to Overdrive Drum .117"	1	95-Up	86214C	67409C
219E	Driven Sprocket Support to Direct/ Intermediate Drum .056"-.062"	1	95-Up	86219	67400
219E	Driven Sprocket Support to Direct/ Intermediate Drum .064"-.070"	1	95-Up	86219A	67400A
219E	Driven Sprocket Support to Direct/ Intermediate Drum .076"-.080"	1	95-Up	86219B	67400B
219E	Driven Sprocket Support to Direct/ Intermediate Drum .085"-.089"	1	95-Up	86219C	67400C
229B	Forward Drum to Low Sprag (4 Tab) (Black .065")	1	95-Up	86229A	67211
232F	Direct/Intermediate Clutch Drum to Direct Sprag (2 Tab)	1	95-Up	86232	67210
258D	Low/ Intermediate Clutch Hub to Low/ Intermediate Spring Retainer (6 tab)	1	95-Up	86258H	67217A
278/9E	Drive Sprocket to Converter Reactor & to Case Cover (3 Uneven Spaced Tabs)	2	95-Up	86279	67213
278/9E	Drive Sprocket to Converter Reactor & to Case Cover (3 Even Spaced Tabs)	2	95-Up	86279A	67213A
280E	Driven Gear to Case Cover 3 Tab Plastic	1	95-Up	86280A	67214A
281E	Driven Sprocket to Direct/Intermediate Support (Plastic)	1	95-Up	86281	67212
293H	Differential to Case .064"-.069"	1	95-Up	86293B	67401A
293H	Differential to Case .061"	1	95-Up	86293C	67401C
293H	Differential to Case .065"	1	95-Up	86293CA	67401D
293H	Differential to Case .072"	1	95-Up	86293CC	67401F

FORD AX4N (4F50N)

ILL.	DESCRIPTION	QTY.	YEAR	PART NO.	REFERENCE NO.
BEARINGS & RACES					
201D	Bearing Kit	1	95-Up	86201H	K67906B
209	Bearing, Pump Needle Bearing	1	95-99	86209	67922
209	Bushing, Replaces Pump Needle Bearing	1	95-Up	86209B	N/A
209	Bearing, Pump Shaft (1.002"OD)	1	96-99	86209C	67922A
209	Bearing, Pump Shaft (1.065"OD)	1	00-Up	86209H	67922B
220E	Bearing w/ Race, Driven Sprocket Support to Direct/ Intermediate Drum	1	95-Up	36217	67225
235C	Bearing w/ Race, Intermediate Hub (Both Sides)	2	95-Up	86235	67224
237G	Needle Bearing, Front Planet Shaft (Outer)	1	95-Up	86237	67004B
238G	Bearing w/ Race, Front Planet to Rear Planet	1	95-Up	86238	67226
241G	Caged Bearing, Front Planet	1	95-Up	86241	67003B
241G	Captured Bearing, Front Planet	1	95-Up	86241A	67228
257	Bearing w/ Race, Rear Sun Gear Drum to Differential Support	1	95-Up	86257H	67444
260H	Bearing w/ Race, Differential Support to Parking Gear	1	95-Up	86260H	67222B
289	Bearing w/ Race, Differential to Sun Gear	1	95-Up	86289	67221
292H	Bearing w/ Race, Differential to Case	1	95-Up	86292	67220
295E	Needle Bearing, Converter Reactor (Inner)	1	95-Up	64295	51486
298E	Needle Bearing, Drive Sprocket Support (Inner)	1	95-Up	86298A	67978
GASKETS & O-RINGS					
300H	Gasket, Bottom Pan (Cork) (Fiber = 86300HF)	1	1995	86300H	13996X
300H	Gasket, Bottom Pan (Bonded Gasket)	1	96-Up	86300HW	13996R
301A	Gasket, Side Cover (Cork) (Fiber = 86301HF)	1	1995	86301H	13997X
301A	Gasket, Side Cover (Bonded Gasket)	1	96-99	86301HW	13997R
301A	Gasket, Side Cover (Steel Cover)	1	00-Up	86301JW	13997BR
301A	Gasket, Side Cover (Aluminum Cover)	1	00-Up	86301KW	13997AR
310A	Gasket, Pump Plate to Pump (No Stripe) AX4N (Pump/VB Gasket Pkg 86320HK)	1	95-97	86310AH	N/A
310A	Gasket, Pump Plate to Pump (Orange Stripe) AX4N (Pump/VB Gasket Pkg 86320HK)	1	98-03	86310AHB	N/A
310A	Gasket, Pump Plate to Pump (White Stripe) 4F50N (Pump/VB Gasket Pkg 86320JK)	1	04-Up	86310AHC	N/A
310A	Gasket, Pump Plate to Valve Body (No Stripe) AX4N (Pump/VB Pkg 86320HK)	1	95-97	86310BH	N/A
310A	Gasket, Pump Plate to Valve Body (Orange Stripe) AX4N (Pump/VB Pkg 86320HK)	1	98-03	86310BHB	N/A
310A	Gasket, Pump Plate to Valve Body (Blue Stripe) 4F50N (Pump/VB Gskt Pkg 86320JK)	1	04-Up	86310BHC	N/A
313A	O-Ring, Oil Pump Slide	1	95-Up	86313	N/A
314A	Seal, Pump Slide (Rubber)	1	95-Up	54314B	13768
315A	Seal, Pump Slide (Teflon)	1	95-Up	54315B	13762
320A	Bonded Valve Body Gasket, # No Stamp (Taurus, Sable w/ 3.0L)	1	94-95	86320HA	13813A
320A	Bonded Valve Body Gasket, # 11	1	95-97	86320HB	13813B
320A	Bonded Valve Body Gasket, # 13 or # 14	1	96-97	86320HC	13813C
320A	Bonded Valve Body Gasket, # 15	1	96-97	86320HD	13813E
320A	Bonded Valve Body Gasket, # 84	1	1998	86320HG	13813T
320A	Bonded Valve Body Gasket, # 85	1	98-99	86320HH	13813V
320A	Bonded Valve Body Gasket, # 86	1	98-99	86320HJ	13813W
320A	Bonded Valve Body Gasket, # 87	1	98-99	86320HM	13813X
320A	Bonded Valve Body Gasket, # 90 or #03	1	99-00	86320HN	13813U
320A	Bonded Valve Body Gasket, # 04	1	01-02	86320HP	13813AV
320A	Bonded Valve Body Gasket, # 05	1	01-03	86320HQ	13813AZ
320A	Bonded Valve Body Gasket, # 01	1	04-Up	86320HR	13813AX
320A	Gasket Package, Pump/Valve Body (86320H, 86321H Avail Separate) AX4N	1	95-97	86320HK	K13812G
320A	Gasket Package, Pump/Valve Body (86320J, 86321J Avail Separate) AX4N	1	98-03	86320HK	K13812G
320A	Gasket Package, Pump/Valve Body (86320L, 86321L Avail Separate) 4F50N	1	04-Up	86320JK	K13812J
324A	Gasket, Case Cover to Case (AX4N)	1	95-99	86324H	13936A
324A	Gasket, Case Cover to Case (AX4N)	1	00-03	86324HA	13936C
324A	Gasket, Case Cover to Case (4F50N)	1	04-Up	86324HB	13936D
339G	Lip Seal, Reverse Clutch (Outer)	1	95-Up	86339	N/A
354H	Lathe Cut Seal, 3-4 Accumulator Piston	1	95-Up	86354	N/A
367H	Seal, Overdrive Servo Cover (Thin Wall)	1	95-Up	86367	13939
380E	O-Ring, Turbine Shaft	1	95-Up	86380H	13020

AX4N

FORD AX4N (4F50N)

ILL.	DESCRIPTION	QTY.	YEAR	PART NO.	REFERENCE NO.
TECHNICAL MANUALS					
400D	Tech Manual	1	95-Up	86400H	67Y04
ELECTRICAL COMPONENTS					
410A	Switch, Manual Lever Position (MLPS) (8 Pin Connector)	1	96-98	86410EA	15A-127
410A	Switch, Manual Lever Position (MLPS) (10 Pin Connector)	1	98-Up	86410HA	15A-128A
410A	Switch, Manual Lever Position (MLPS) (11 Pin Connector)	1	96-99	86410H	15A-128
420A	Solenoid, Shift (1-2, 2-3, 3-4)	3	95-Up	86420	5A-259
420A	Solenoid, Shift (1-2, 2-3, 3-4) (Teckpak)	3	95-Up	T86420	5A-259
420A	Solenoid Master Kit	1	95-Up	86420HK	N/A
425A	Solenoid, Modulated Lock-Up (White).....	1	95-96	86425B	5A-257A
425A	Solenoid, Modulated Lock-Up (Blue).....	1	97-Up	86425H	5A-257B
431A	Solenoid, Electronic Pressure Control (EPC)	1	95-Up	86431HA	5A-258B
436	Sensor, Vehicle Speed (VSS) Cable Drive .876" Diameter	1	95-99	36436	20A-412
436	Sensor, Vehicle Speed (VSS) Cable Drive 1.100" Diameter	1	95-99	86436	20A-413
436	Sensor, Vehicle Speed (VSS) Gear Driven (20 T Gear)	1	95-99	86436H	20A-413A
436	Sensor, Vehicle Speed (VSS) (13" Harness)	1	00-Up	86436HA	20A-109D
437	Sensor, TOT/TFT (Transmission Oil Temp)	1	95-Up	86437	20A-104
438A	Sensor, Input Speed (TSS) (2 Prong Oval Connector w/ Red/Pink Insert) 2 O-Rings ...	1	95-00	86438A	20A-105B
438A	Sensor, Input Speed (TSS) (2 Prong Square Connector No Insert) 1 O-Ring	1	01-Up	86438B	20A-105C
445	Repair Kit, Wire Harness (VSS)	1	95-Up	76445C	35A-255
445	Repair Kit, External Wire Harness	1	95-Up	86445EHK	35R-254
445	Repair Kit, Wire Harness (Engine Control Module).....	1	95-Up	86445HK	N/A
446	Wire Harness, Internal (AX4N)	1	95-03	86446HA	25A-113D
446	Wire Harness, Internal (4F50N)	1	04-Up	86446HB	25A-113E
HARD PARTS					
Prefix Key: D = OEM, A = Aftermarket New, R = Remanufactured					
PUMPS					
500A	Pump (Cast # RF-F4)	1	95-97	86500H	67920H
500A	Pump (Cast # RF-F8)	1	98-99	86500HA	67920J
500A	Pump (Cast # RF-XF)	1	00-Up	86500HB	67920L
520A	Pump Cover	1	95-Up	86520H	67924
529E	Converter Reactor (Support) 3 Uneven Spaced Holes for Washer # 86279	1	1995	86529	N/A
529E	Converter Reactor (Support) 3 Even Spaced Holes for Washer # 86279A	1	96-Up	86529A	67976A
531A	Rotor Kit	1	95-Up	86531	K67801
532A	Rotor, Pump	1	95-Up	86532	67802
533A	Vane, Pump	7	95-Up	86533	67805
534A	Pump Slide	1	95-Up	86534	67803
538A	Ring, Pump Vane	2	95-Up	86538	67303
DRUMS & CLUTCH HUBS					
550B	Overdrive (36 Lugs For Shell)	1	95-Up	86550H	67945B
552C	Direct & Intermediate (5 Clutch Direct, 5 Clutch Intermediate)	1	95-Up	86552H	67963B
554F	Forward (4 Clutch, 4.5" Tall) (Exc. SHO).....	1	95-Up	86554H	67964E
556G	Reverse (.440"OD Oil Hole).....	1	95-Up	86556H	67962A
559D	Coast w/ Sun Gear	1	95-Up	86559H	67955C
562C	Piston Kit, Intermediate Clutch	1	95-Up	86562H	N/A
564B	Piston Kit, Forward Clutch	1	95-Up	86564H	N/A
565F	Piston Kit, Direct Clutch.....	1	95-Up	86565H	N/A
567D	Piston Kit, Low/ Intermediate Clutch	1	95-Up	86567H	N/A
572C	Clutch Hub, Intermediate (1.580" Tall, .950" Hub Diameter, 1.000" Long Splines)	1	95-Up	86572B	67944A
572C	Clutch Hub, Intermediate (1.750" Tall, 1.100" Hub Diameter, 1.100" Long Splines)	1	95-Up	86572C	67944B
575F	Clutch Hub, Direct Overrun (.830" Thick).....	1	95-Up	86575A	67942B
577D	Clutch Hub & Outer Race, Low/ Intermediate Clutch.....	1	95-Up	86577H	67934

FORD AX4N (4F50N)

ILL.	DESCRIPTION	QTY.	YEAR	PART NO.	REFERENCE NO.
PLANETS					
582G	Front.....	1	95-Up	86582H	67950C
584G	Rear.....	1	95-Up	86584H	67951B
583	Planet Kit (w/ Front Planet, Rear Planet, 36 Lug Sun Shell).....	1	95-Up	86583H	K67960C
594D	Ring Gear, Rear.....	1	95-Up	86594	67952
598H	Ring Gear, Final Drive (25 Lugs).....	1	95-Up	86598H	67985B
598H	Ring Gear, Final Drive (32 Lugs).....	1	98-Up	86598HA	N/A
SUN GEARS, SHELLS & SUPPORTS					
618H	Sun Gear, Final Drive (29 T, 5 1/4" Long).....	1	01-Up	86618HA	67970D
618H	Sun Gear, Final Drive (30 T, 5 1/4" Long).....	1	95-01	86618H	67970B
620C	Shell, w/ Front Sun Gear (w/ 36 Drive Lugs, 1 Bushing).....	1	95-Up	86620B	67948B
N.I.	Sun Shell Kit (w/ Front Planet, Rear Planet, 36 Lug Sun Shell).....	1	95-Up	86583H	K67960C
SPRAGS					
652D	One Way Clutch, Low/ Intermediate (Spring, Roller, Cage) 7 Tab.....	1	95-Up	86652H	67933
656F	Roller Clutch, Direct (.590"/Gray Plastic).....	1	95-Up	86656A	67940A
658B	Sprag, Low Clutch (30 Elements) Replaces 16 & 26 Element Versions.....	1	95-Up	86658A	67930
666F	Inner Race, Direct Overrun Clutch (1/2" Wide Bushing).....	1	95-Up	86666A	67941B
669B	Outer Race, Overrun Clutch (.720" Thick, 57 T).....	1	95-Up	86669A	67931A
SHAFTS					
671E	Pump Shaft.....	1	95-Up	86671	67921
671E	Pump Shaft, Improved Lube Flow.....	1	95-Up	S86671	67921S
673E	Turbine Shaft (25 Spline).....	1	95-Up	86673B	N/A
678D	Output Shaft, 19 1/4" Long (34 Spline on Differential End).....	1	95-Up	86678H	67993B
678D	Output Shaft, 19 1/4" Long (35 Spline on Differential End).....	1	95-Up	86678HA	67993D
CHAINS					
700E	Chain, 3/4" Wide Sprocket, 86 Rocker Pins (HV075).....	1	95-Up	86700HA	67973B
700E	Chain, 3/4" Wide Sprocket, 86 Round Pins (HV021) (1 Copper Link).....	1	95-Up	86700	67973
700E	Chain, 3/4" Wide Sprocket, 88 Rocker Pins (HV092) 4F50N 3.9L.....	1	05-Up	86700HB	67973F
700E	Chain, 3/4" Wide Sprocket, 88 Round Pins (HV092) (2 Copper Links).....	1	95-Up	86700HC	67973H
700E	Chain, 3/4" Wide Sprocket, 88 Round Pins (HV041) (2 Copper Links).....	1	95-Up	86700G	67973D
700E	Chain, 7/8" Wide Sprocket, 88 Rocker Pins (HV042) (1 Dark Blue Link).....	1	95-Up	86700H	67973C
SPROCKETS & SUPPORTS					
705E	Sprocket, Drive (35 T) (Narrow, 4.012"OD).....	1	95-Up	86705CA	N/A
705E	Sprocket, Drive (38 T) Wide, 4.470" OD).....	1	95-Up	86705HF	N/A
706E	Sprocket, Driven w/ Shaft (39 T) (Wide, 4.415"OD).....	1	95-Up	86706HD	N/A
706E	Sprocket, Driven w/ Shaft (39 T) (Wide, 4.425" OD).....	1	95-Up	86706HG	N/A
706E	Sprocket, Driven w/ Shaft (39 T) (Wide, 4.490" OD).....	1	95-Up	86706HF	N/A
710	Sprocket Kit, w/ Turbine (34 T / 39 T) (Rocker Pin, 3/4" Wide).....	1	95-Up	86710HGK	K67984L
710	Sprocket Kit, w/ Turbine (35 T / 38 T) (Rocker Pin, 3/4" Wide).....	1	95-Up	86710CAK	K67984J
710	Sprocket Kit, w/ Turbine (38 T / 39 T) (Round Pin, 3/4" Wide) (Windstar).....	1	95-Up	86710HHK	K67984M
713E	Support, Driven Sprocket w/ Notch (Cast RFF4DP).....	1	95-Up	86713H	67977B
DIFFERENTIALS					
715H	Differential (35 Spline Axles) (Less Speed-O-Gear).....	1	95-Up	86715	K67980A
715H	Differential (34 Spline Axles) (Less Speed-O-Gear) (5 Pinion) (Cast 2F2P).....	1	95-Up	86715H	67980
715H	Final Drive Package (Carrier, Sun Gear, Ring Gear) (29 T).....	1	95-01	86715HAK	K67980C
715H	Final Drive Package (Carrier, Sun Gear, Ring Gear) (30 T).....	1	95-01	86715HK	K67980E
724H	Support, Differential (Low/ Interm Clutch Housing) (Aluminum).....	1	95-99	86724H	K67965C
724H	Support, Differential (Low/ Interm Clutch Housing) (Aluminum) (Cast RF1F1P).....	1	00-Up	86724HA	N/A
.	Support has a cutout for the VSS sensor.....				

AX4N

FORD AX4N (4F50N)

ILL.	DESCRIPTION	QTY.	YEAR	PART NO.	REFERENCE NO.
VALVE BODIES					
740A	Valve Body (Premium) Cast RFF4	1	94-98	86740-2	P67990H
740A	Valve Body (Premium) Cast RFF8 or RF-XF1	1	98-03	86740-3	P67990J
740A	Valve Body (Premium) 4F50N.....	1	04-Up	86740-8	P67990M
VALVE BODY COMPONENTS					
741D	Valve & Sleeve, Boost (.475") 3.0L w/ O-Ring	1	95-Up	86741TBK	K67971B
741D	Valve & Sleeve, Boost (.475") 3.0L	1	95-Up	86741TCK	K67971C
741D	Valve & Sleeve, Boost (.491") 3.8L w/ O-Ring	1	95-Up	86741TK	K67971
741D	Valve & Sleeve, Boost (.491") 3.8L	1	95-Up	86741TAK	K67971A
741D	Check Ball, Valve Body, 5/16" (.312")	AR	95-Up	76741-5	13924A
741D	Valve, Manual.....	1	95-Up	86741M-1	67972
741D	Retainer, Valve Body Forward Clutch Control Valve.....	1	95-Up	86741-4	67961D
741D	Sleeve, Valve Body to Pump Shaft (Press-In)	1	95-Up	86741V	67641
741D	Sleeve & Plunger, Bypass Clutch Control (.486" Diameter).....	1	95-Up	86741HBK	K67967D
741D	Sleeve & Plunger, Bypass Clutch Control (.496" Diameter).....	1	95-Up	86741HCK	K67967F
741D	Sleeve & Plunger, Line Pressure Modulator (.427" Valve)	1	95-Up	86741HDK	K67974
741D	O-Rings for S86741HDK	1	95-Up	ORMK-4	N/A
741D	Spring, Pressure Regulator (Elevated).....	1	95-Up	86741P-3	K67832
741D	Valve, Pressure Regulator w/ Springs (Oversized) (requires T-96206-TL2).....	1	95-Up	86741PK	K67886
741D	Valve, Accum Pressure Control (requires T-36948-TL)	1	95-Up	86741EK	K67879
741D	Valve Kit, Forward Control (requires T-96206-BST)	1	95-Up	86741HSK	K67979C
741D	Valve Kit, Oversized Solenoid Regulator (requires T-96201-TL2).....	1	95-Up	86741LK	K67884
741D	Valve Kit, Oversized Converter Regulator (requires T-96201-TL3).....	1	95-Up	86741QK	K67885
741D	Valve Kit, Oversized Bypass Clutch Control (requires T-96206-TL).....	1	95-Up	86741HBBK	K67967N
CASES & HOUSINGS					
755A	Case Cover (Cast # RFF4DP-7G234-BA)	1	95-Up	86755H	67995J
755A	Case Cover (Cast # RFF6DP-7G234-BA)	1	96-Up	86755HD	67995H
755A	Case Cover (Cast # RFF6DP-7G234-BA)	1	01-02	86755HE	67995L
755A	Sleeve, Channel Plate Sleeve (2 Per Kit).....	1	95-Up	86755-2	N/A
760H	Case (3.0L w/ Dual OHC) (No Speed-O Hole)	1	96-99	86760HC	N/A
760H	Case (3.0L w/ Dual OHC) (w/ Speed-O Hole).....	1	95-99	86760H	N/A
760H	Case (3.2L).....	1	95-Up	86760HA	N/A
765H	Pan, Bottom.....	1	95-Up	86765H	N/A
766A	Pan, Side (Valve Body Cover)	1	95-Up	86766H	67988B
766A	Pan, Side (Valve Body Cover) (Aluminum)	1	00-Up	86766HA	67988C
854G	Cushion Spring, Reverse (4-51/64" ID).....	1	95-Up	86854	67715
125C	Cushion Spring, Intermediate (.071", 8 T)	1	95-Up	86129HA	67715C
125B	Cushion Spring, Forward (.083")	1	95-Up	86129H	67715E
857D	Cushion Spring, Low/ Intermediate Clutch (.070").....	1	95-Up	86857H	67715H
SNAP RINGS					
878B	Forward, Direct, & Intermediate .056"	1	95-Up	86878	N/A
878B	Forward, Direct, & Intermediate .067"	1	95-Up	86878A	N/A
878B	Forward, Direct, & Intermediate .078"	1	95-Up	86878B	N/A
878B	Forward, Direct, & Intermediate .092"	1	95-Up	86878C	N/A
878B	Forward, Direct, & Intermediate .101"	1	95-Up	86878D	N/A
878B	Forward, Direct, & Intermediate .111"	1	95-Up	86878E	N/A
MISCELLANEOUS COMPONENTS					
902H	Piston, Overdrive Servo (Uses 1.050"OD Spring) (95-7/97)	1	95-E97	86902	67528
902H	Piston, Overdrive Servo (Uses 1.700"OD Spring) (7/97-Up).....	1	L97-Up	86902A	67528B
902H	Piston & Pin Kit, Overdrive Servo (No Groove on Pin)	1	98-Up	86902AK	67949E
903H	Pin, Overdrive Servo (No Groove).....	1	95-Up	86903	67949
903H	Pin, Overdrive Servo (1 Groove)	1	95-Up	86903A	67949A
903H	Pin, Overdrive Servo (2 Groove) (Uses 1.050" OD Spring)	1	95-Up	86903B	67949B

